

Ex-Adapter und Ex-Reduzierungen
Ex-adaptors and Ex-reducers

476

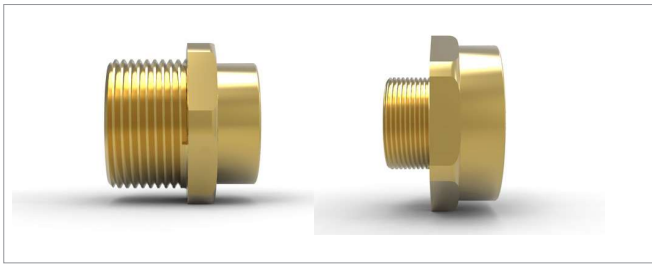

Zum Erweitern oder Reduzieren einer Gewinde- oder Durchgangsbohrung auf eine andere Gewindegröße oder Gewindeart.

To adapt or reduce threaded or clearance holes to another size or thread type.

Internationale Zulassungen / International Approvals



TECHNISCHE DATEN:	
Verfügbare Werkstoffe	Messing Messing vernickelt Edelstahl 1.4404, V4A, 316L Aluminium
Kennzeichnung	Ex e IMb Ex d IMb Ex e IIC Gb Ex d IIC Gb Ex tb IIIC Db IM2 / II 2GD
Zulassungen	ATEX/IECEx NEC/CEC/CSA/UL CCC EAC EQM Inmetro SONCAP
Marine-Zulassungen	DNV Bureau Veritas ABS
Zonen & Gasgruppen	Zone 1, Zone 2, Zone 21, Zone 22 Gasgruppen IIA, IIB und IIC
Temperaturbereich	-60 °C / +200 °C
Gewindearten	metrische Gewinde M12 bis M130 NPT-Gewinde 3/4" NPT bis 6"NPT
Weitere Gewindearten	BSPP, BSPT, PG, ET und NPSM
Schutzart	IP66 (bei montierter Hawke Flachdichtung)
Prüfnorm	IEC/EN 60079-0 IEC/EN 60079-1 IEC/EN 60079-7 IEC/EN 60079-31
Hinweis	Weitere Produktinformationen stellen wir Ihnen gerne zur Verfügung.

TECHNICAL DATA:	
Available materials	Brass Nickel plated brass Stainless Steel 1.4404, V4A, 316L Aluminium
Marking	Ex e IMb Ex d IMb Ex e IIC Gb Ex d IIC Gb Ex tb IIIC D IM2 / II 2GD
Approvals	ATEX/IECEx NEC/CEC/CSA/UL CCC EAC EQM Inmetro SONCAP
Marine Approvals	DNV Bureau Veritas ABS
Zones & Gas groups	Zone 1, Zone 2, Zone 21, Zone 22 Gas groups IIA, IIB and IIC
Temperature range	-60 °C / +200 °C
Thread options	metric threads M12 to M130 NPT threads 3/4"NPT to 6"NPT
Other thread options	BSPP, BSPT, PG, ET and NPSM
Protection grade	IP66 (when installed with a Hawke washer)
Test standard	IEC/EN 60079-0 IEC/EN 60079-1 IEC/EN 60079-7 IEC/EN 60079-31
Remark	Further product information is available upon request.



MADE IN BRITAIN



International Approvals

476

Adaptors and Reducers

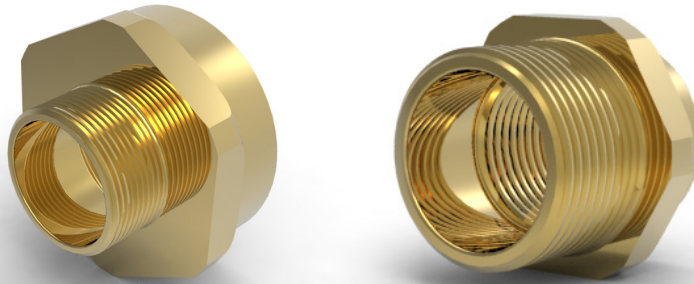

Metallic Adaptor and Reducer Range; designed to increase or reduce entry thread sizes when mounted to an enclosure. Suitable for use in Flameproof and Increased Safety protection concepts along with mining applications

Technical Data

Ingress Protection	IP66*
Operating Temperature	-60°C to +160°C
Construction Materials	Manufactured in Brass (Standard), Nickel Plated Brass or 316L Stainless Steel
Threadform	M16 to M130** 3/8" NPT to 6" NPT

*In order to maintain IP rating at the joints a suitable sealing method must be used.

**For M16-M75: Metric Thread Length 15mm as standard; Metric Thread Pitch 1.5mm as standard

For M80-M130: Metric Thread Length 20mm as standard; Metric Thread Pitch 2mm as standard

Approvals

Applications	Suitable for Use in Zone 1, Zone 21, Zone 2, Zone 22 and mining applications
Protection Class	Ex II 2GD Ex db eb IIC Gb; Ex tb IIIC Db Ex I M2 Ex db eb I Mb
Construction & Test Standards	IEC/EN 60079-0, IEC/EN 60079-1, IEC/EN 60079-7 and IEC/EN 60079-31
ATEX Certificate No	Baseefa 11ATEX0067X
UKEx Certificate No	BAS21UKEX0057X
IECEX Certificate Number	IECEX BAS11.0037X
Marine Approvals	ABS: 17-LD1653734-PDA BV: 43523/A1
Additional Certifications	CCC: 2020312313000308 EN EAC: No EA3C RU C-GB.HA91.B.00265/21 EQM: 20-11-27224/Q20-11-000979/NB0007 Inmetro: IEx 15.0193X SONCAP: LCOGB049552-0500

NEC/CEC

NEC Protection Class	CI ABCD CII EFG CIII: CI Zn1 AEx d e IIC Gb; Zn 21 AEx tb IIIC Db
CEC Protection Class	Ex db eb IIC Gb; Zn 21 Ex tb IIIC Db
c CSA us Certificate	1731876
Construction & Test Standards	CSA C22.2 No. 25-1966, 30-M1986, 45-M1981, 94-M91, 18.3.-12 CSA/UL 60079-0, CSA/UL 60079-1, CSA/UL 60079-7, CSA/UL 60079-31, UL514B

Ordering Information

Product	Male Thread Size	Female Thread Size	Material	Finish
476	M40	M32	Brass	NP

476 Allowable Thread Combinations																			
KEY: A = Adaptor R = Reducer	Female Thread																	Metric	
	M16 3/8"	M20 1/2"	M25 3/4"	M32 1"	M40 1 1/4"	M50 1 1/2"	M63 2"	M75 2 1/2"	M80 3"	M90 3 1/2"	M100 4"	M110 5"	M115 6"	M120	M130	5"	6"	NPT	
Male Thread	M16 3/8"	A	A	A															
	M20 1/2"	R	A	A	A														
	M25 3/4"	R	R	A	A	A													
	M32 1"	R	R	R	A	A	A												
	M40 1 1/4"	R	R	R	R	A	A	A											
	M50 1 1/2"	R	R	R	R	R	A	A	A										
	M63 2"	R	R	R	R	R	R	A	A	A									
	M75 2 1/2"	R	R	R	R	R	R	R	A	A	A								
	M80 3"	R	R	R	R	R	R	R	R	A	A	A							
	M90 3 1/2"	R	R	R	R	R	R	R	R	R	R	A	A	A					
	M100 4"	R	R	R	R	R	R	R	R	R	R	R	A	A	A				
	M110 5"	R	R	R	R	R	R	R	R	R	R	R	R	A	A	A			
	M115 6"	R	R	R	R	R	R	R	R	R	R	R	R	R	A	A	A		
	M120	R	R	R	R	R	R	R	R	R	R	R	R	R	R	A	A		
	M130	R	R	R	R	R	R	R	R	R	R	R	R	R	R	R	A		
	5"	R	R	R	R	R	R	R	R	R	R	R	R	R	R	R	R	A	
	6"	R	R	R	R	R	R	R	R	R	R	R	R	R	R	R	R	R	A
Metric	NPT																		